



### Selecting between the 32-bits or the 64-bits version.

If you don't have Office installed, then you can select either one (e.g., 32 or 64 bits). Microsoft provides some additional, optional considerations to select an architecture in this [link](#).

On the other hand, if you have office installed, then: (1) open Access, Office or Excel, (2) go to Account and (3) click on "About" button as shown Figure 1 below. The architecture will be next to the name of the application as shown in the figure below. FAD TOOLS installation should match this architecture, therefore, use the installer in the "##\_Bits\_Version\_Installer" folder, where is ## is 32 or 64 bits according to the corresponding architecture.

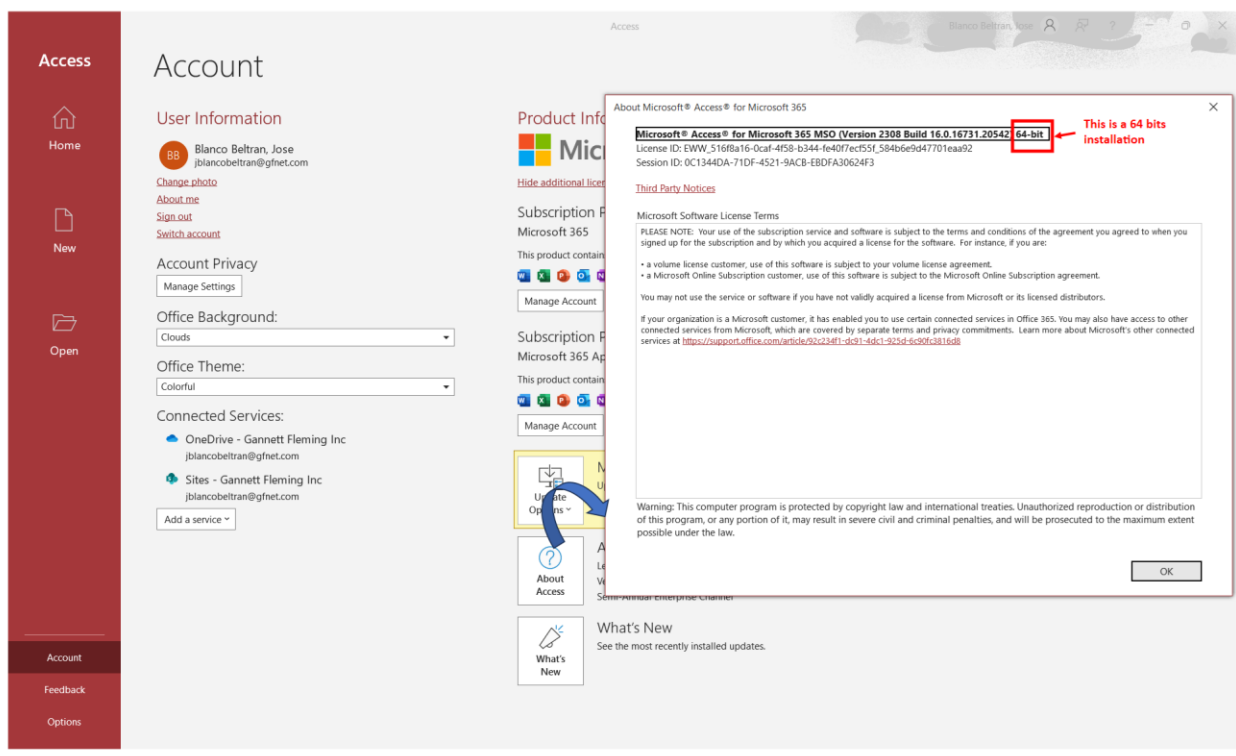

Figure 1. Office's architecture based on Access installed in the computer.